

# 600 Basin Unit

**ROPER RHODES®**  
BATH



**Handle Specification: Chalk White**  
No. of Handles - 2  
Screw Dimensions - 2 x (4mm x30mm)

**All other finishes:**  
No. of Handles - 2  
Screw Dimensions 2 x (4mm x 29mm)



NO.	DESCRIPTION	PRODUCT CODE	FIXINGS INCLUDED?	GROSS WEIGHT	NET WEIGHT
1	HAMPTON 550mm COUNTERTOP UNIT	HAM550B	YES	20.4kg	20.4kg
2	HAMPTON 560mm COUNTERTOP BASIN 1TH	HAM560C	N/A	15.7kg	15.7kg
3	HAMPTON 560mm COUNTERTOP BASIN 2TH	DC14001	N/A	15.7kg	15.7kg

## DIMENSIONS

DIAGRAMS NOT TO SCALE  
ALL DIMENSIONS IN MM  
TOLERANCE OF ± 5MM

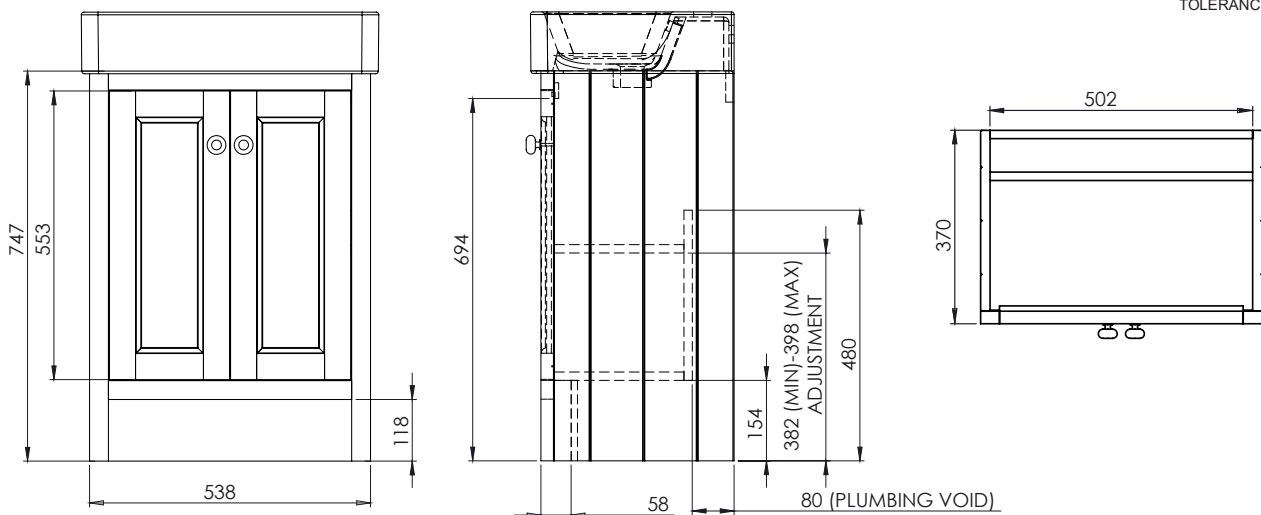

## FAQ

What is the depth of the unit with the door open? 590mm

What is the width of the unit with the door open? 895mm

How deep are the shelves? 250mm

Can I repair small areas of damage? Yes, we can supply small touch up paint pens for small paint repairs.

How is the unit secured in place? The unit can be secured to the wall through the upper brace at the rear of the unit. Fixings not supplied.

What is the Internal Water Depth? 65mm

What is the distance between the two tap holes on 2TH version? 200mm