

AFTERCARE INSTRUCTIONS

Whilst this item has a high quality durable finish, it should nevertheless be treated with care. Surfaces should be cleaned using only a soft damp cloth and clean water & dried using a soft cotton cloth. Bath cleaning products, even non-scratch ones could damage the finished surface.

10-YEAR GUARANTEE

We have complete confidence in this Roper Rhodes product and as such it is offered with a 10-year guarantee against defects in manufacture. The guarantee requires that this product be used in the manner for which it was intended and that it is installed & maintained in accordance with the fitting instructions and local water bylaws. The guarantee covers products in domestic use only. The guarantee is invalidated should the tap be damaged by water borne debris. Make sure that supply pipes are clear of any debris prior to installation, this is particularly important on new plumbing installations. In the unlikely event that this product should fail during the guarantee period we will either replace the faulty part or the complete unit as appropriate.



BATH & BASIN TAP

Installation & aftercare instructions

Please retain for future reference

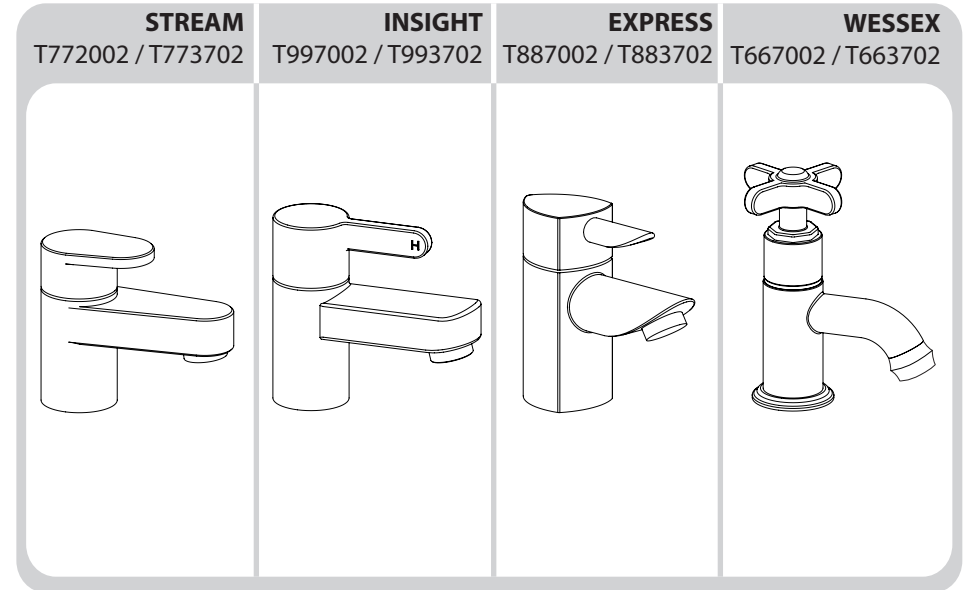

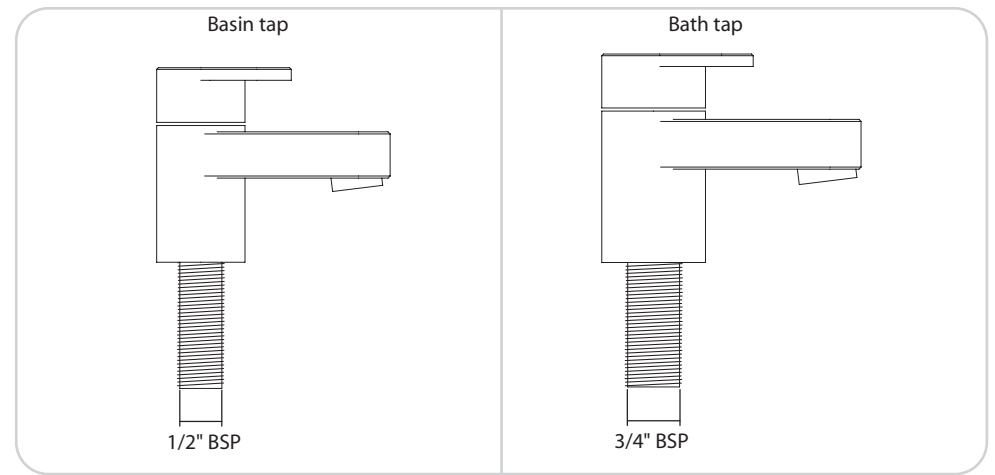
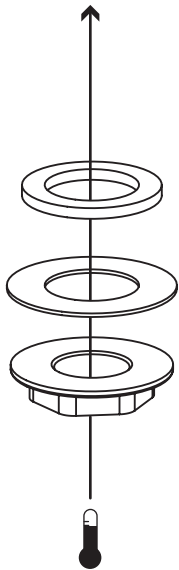
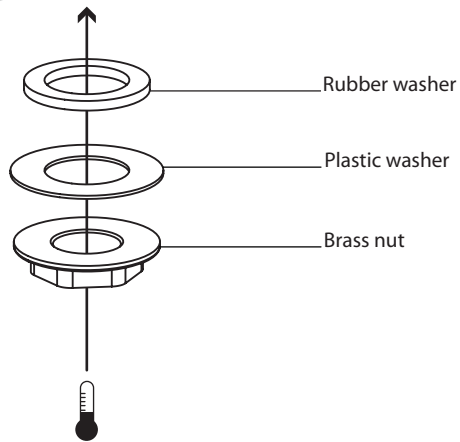
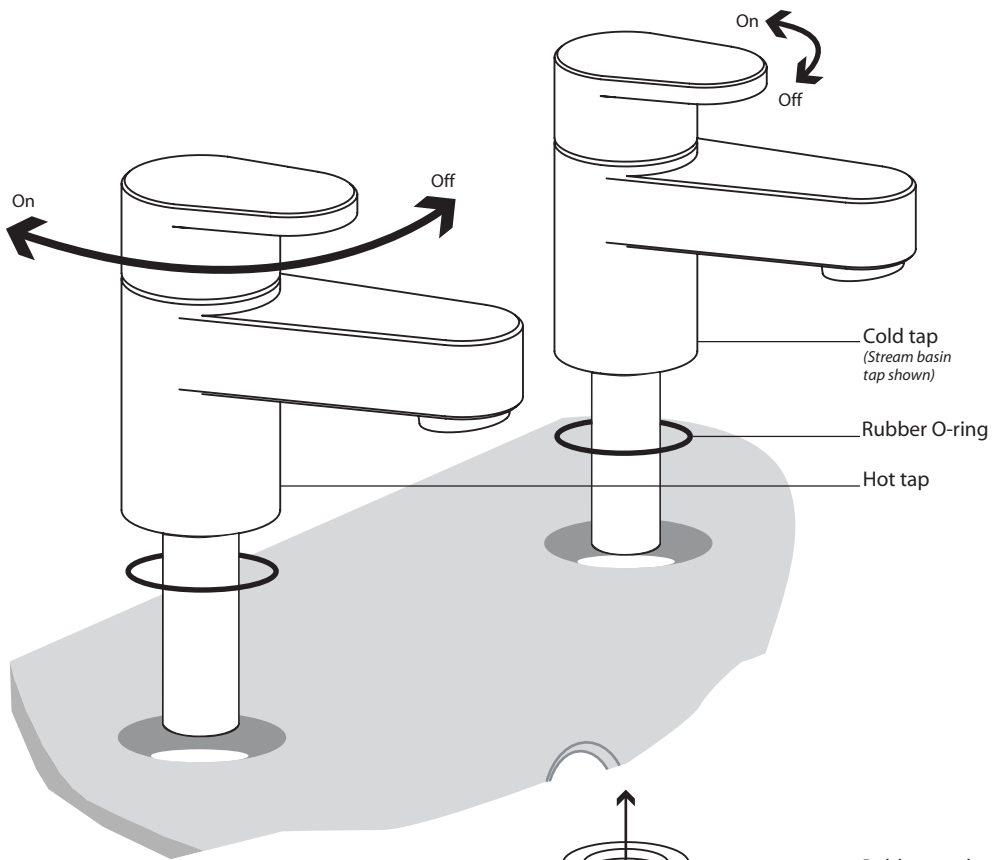

INSTALLATION PROCEDURE

1. Prior to installation flush out the pipe work to remove debris & then ensure that the water supply is turned off.
2. Refer to diagram & check that all components are present.
3. Install both taps onto the basin in the sequence shown in the diagram using the washers and brass nuts provided.
4. Connect the water supply using PTFE tape to help create the seal.
5. Fully open both taps & allow water to run for approximately one minute to further flush the system.
6. Check all connections for leaks.

GENERAL NOTES

These taps should be installed in accordance with building regulations. Approved check valves should be fitted where required. For further details please contact your local water authority.